



WHAT'S INCLUDED IN MY
Premium Handcrafted
Scribed Fit
Stacked Wall
Log Shell Package?



MAILING: PO Box 295, Salmon Arm, BC V1E4N3 Ph:250.836.3854 Fax: 250.836.3874

OFFICE: 301 Main Street, Sicamous, BC

BUILDING SITE: 3464 Oxbow Frontage Road, Malakwa, BC

Contents

Introduction	3
Design Services	3
Premium Handcrafted Logs.....	4
Walls, Corners and Tails	7
Post and Beam Log Floor & Roof Systems	7
Preparation for Framing and Electrical	8
Log Openings for Windows and Doors	10
Gaskets and Insulations	10
Bolting and Hardware.....	11
Beautiful Handcrafted Stairs and Railings.....	12
Shipping & Set-up	12

Introduction

Thank you for your interest in Lake Country Log Homes! This publication is designed to offer you a general overview of what will be included with your Premium Handcrafted Stacked Log Wall Log Shell Package.

Design Services

Phase 1 Preliminary Drawings

Includes

- Floor Plans
- Elevations
- Sections
- Perspective View
- 3D Renderings
- 3D Animated Walkthrough



Our design team will ensure your home is the best possible reflection of your wants and needs. We will custom design your log home using notes, ideas and sketches or by modifying an existing plan. We will work with you for as long as it takes to get your design exactly how you want. Just prior to preparing the construction drawings, you will get an Animated 3D Walkthrough of your home.

Phase 2 Construction Drawings

Includes

- | | |
|---|--|
| <ul style="list-style-type: none"> • Site Plan • Floor Plans • Elevations • Sections • Building Details • Framing Details | <ul style="list-style-type: none"> • Foundation Plan • Subfloor Plan • Roof Plan • Electrical / Mechanical Plan • Door and Window Schedules |
|---|--|

Designed for your local building codes and requirements and ready for you to submit for building permits.

Structural Engineering

Includes

- Structural Engineering
- Seal by Certified Structural Engineer (Site inspections not included)

During this stage we work with a structural engineer and incorporate structural notes and calculations in the plans. We can also include any additional details that you or your construction crew request.

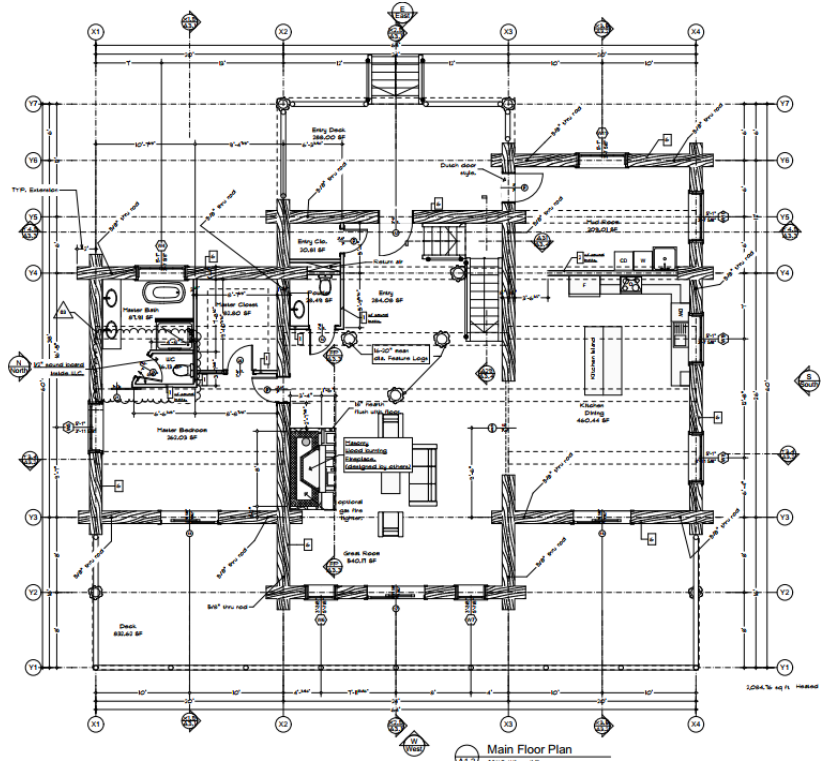

Premium Handcrafted Logs

A stacked log home features main floor walls consisting entirely of logs stacked horizontally on top of each other with a post and beam floor and roof system. Your log shell package includes beautiful logs which are hand peeled and expertly crafted. All our logs meet or exceed premium and structural TPI Grading Standards. (These standards far exceed the requirements for log home construction. However, we will use nothing less). During manufacturing and upon completion, all logs are treated with a formula that contains UV protection and fungicide. The formula lasts up to six months and minimizes sun discoloration, mold and checking. For an additional cost, Lake Country can do the final staining/finishing of your logs before delivery.

Species Available

Western Red Cedar

Sourced primarily from British Columbia's Haida Gwaii and Vancouver Island, Western Red Cedar allows for large diameters and striking design features. This wood contains natural preservatives that deter insects and prevent decay and has a very low shrinkage factor, making it superior in its' ability to resist checking, twisting or warping. It is also an excellent insulator and sound absorber.

See
More



Douglas Fir

This species is known for its pronounced straight grain and reddish heart wood characteristics. It is ideal for log cabin home construction because of the size, length and the consistency of the tree. Because it's grain and texture are very appealing, it is commonly used for doors, trims, flooring and siding. We use Interior Mountain Growth Douglas Fir as opposed to Coastal Growth Douglas Fir (a species that grows much faster and produces large growth rings, making it less stable and increasing checking and shrinkage). Interior Mountain Growth Douglas Fir is a slow growth tree that grows in a tough climate, giving it a tighter growth ring, thereby making it more stable and minimizing checking and movement in the logs.

See
More

Log Diameter

A wide variety of log diameters are available from Lake Country Log Homes, giving you many design possibilities. It's even possible to get logs with a diameter of 80 inches! (The examples below are only typical standards).

Premium Handcrafted Logs (cont'd)

Typical Diameters for Standard Logs

- 16 to 17" (406 to 432 mm) mean diameter for stacked log walls. 18 to 20" (458 to 508 mm) roof beams as required for structure and aesthetics. (For example, vaulted ceilings look better with larger logs.)
- OR
- 14" (356 mm) mean diameter log walls with 16" (406 mm) roof beams as required for structure and aesthetics.

Typical Diameters for Flared Character Western Red Cedar Logs

- 16" to 18" mean diameter logs (larger diameters at Flared Character Butts)
- 18" to 20" ++ mean diameter logs for roof etc.

Also Available

- Specialty Feature Character Logs
All our logs have character, but these have much more. These logs are mainly used for posts and have character throughout. Features include flared character butts, burls, knots catfaces etc.
- Consistent Diameter Logs (aka turned or lathed)



© Lake Country Log Homes (LCLH) www.lakecountrylog.com

Walls, Corners and Tails

Standard Wall Height

Standard log wall height: 10' (3048 mm).

Log Tails

- Straight
- Staggered End
- Staggered End Flared Butt (Western Red Cedar)
- Chiseled Ends
- Custom
- Curled / Arched

Corner Notches

- Scandinavian Saddle Notch
- Diamond / Wedge Notch
- Dovetail



Settling Allowances: Our premium log shell packages contain features that prepare for settling.

Post and Beam Log Floor & Roof Systems

Posts

- Posts supporting upper floor, decks, porch/covered decks and roof beams
- Posts in framed walls flatted and slotted to accept wall finish
- Posts supporting beams at wall

Upper Floor System

- Log beams and joists supporting upper floor flatted on top for floor system and pockets cut for main floor framed wall



Roof System

- Roof members which include (depending on the design):
Ridge Beams, Purlins, Collar Beams, Valley Beams, Hip Beams, Rafters
- Log Roof Beams pitched for roof framing
- Pockets cut in beams for wall framing

Trusses

Trusses are for clear spanning areas in the home. They allow for clear spaces in the floor plan by getting rid of the need for posts. Because of their striking appearance, they are often placed in feature locations. We offer several different styles of log trusses. These include a variety of styles: from the traditional King and Scissor Trusses to our Custom Hanging Feature Character King Post Truss (seen in the photo and most commonly chosen by our clients).



See
More

Preparation for Framing and Electrical

Post Slabbing and Slotting

Where framed walls run perpendicular to a post, the post is slabbed (flattened) and two vertical grooves are made so the sheathing can run past the framing for a more finished look. For framed walls that line a log wall, the post is only slabbed but not slotted.



Log Wall Slabbing

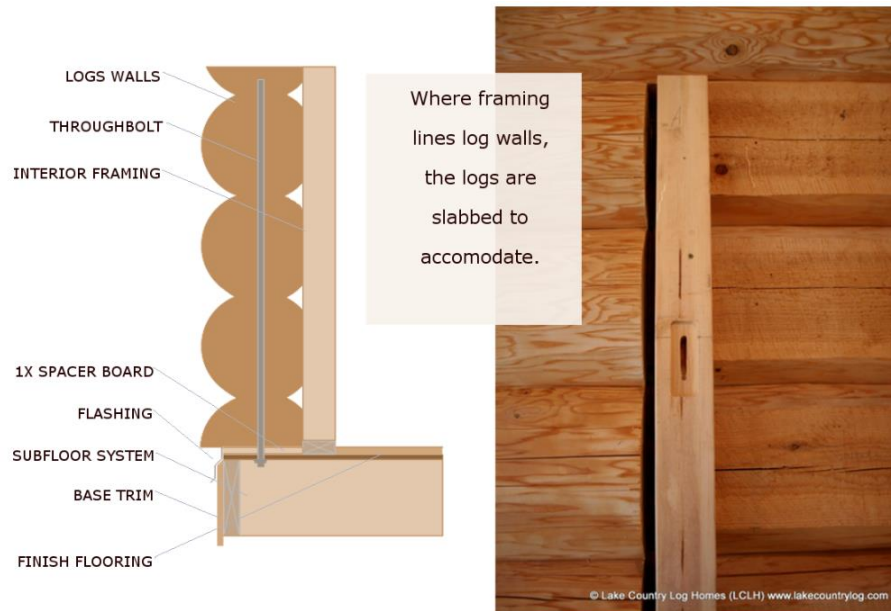

Log Wall Slotting

Where a framed wall intersects a log wall, two vertical cuts are made in the logs. This allows the framing to be butted against the logs and the sheathing to be tucked into the cuts.

Sloping of Ridgepoles, Purlins and Top Logs

Log members are perfectly sloped to accommodate rafter pitch.

Pre-drilling for Electrical

Log Walls pre-drilled and outlet boxes pre-cut and flattened. Electrical plans made to local code and outlet locations are according to the clients' request.



Log Openings for Windows and Doors

Well-designed windows and doors are central features that will perfectly compliment your log home. A beautiful and well-placed exterior door will welcome you to your natural cocoon. Windows will allow light and natural beauty to infiltrate and augment the already natural surroundings you live in. Looking out at a forest from within a log home makes for a complete and perfectly harmonious view. Given the importance of windows and doors to your enjoyment, it is important that your log shell package is properly designed prepare for their installation. Our expert craftsmen prepare log openings for quick installation of your windows and doors.

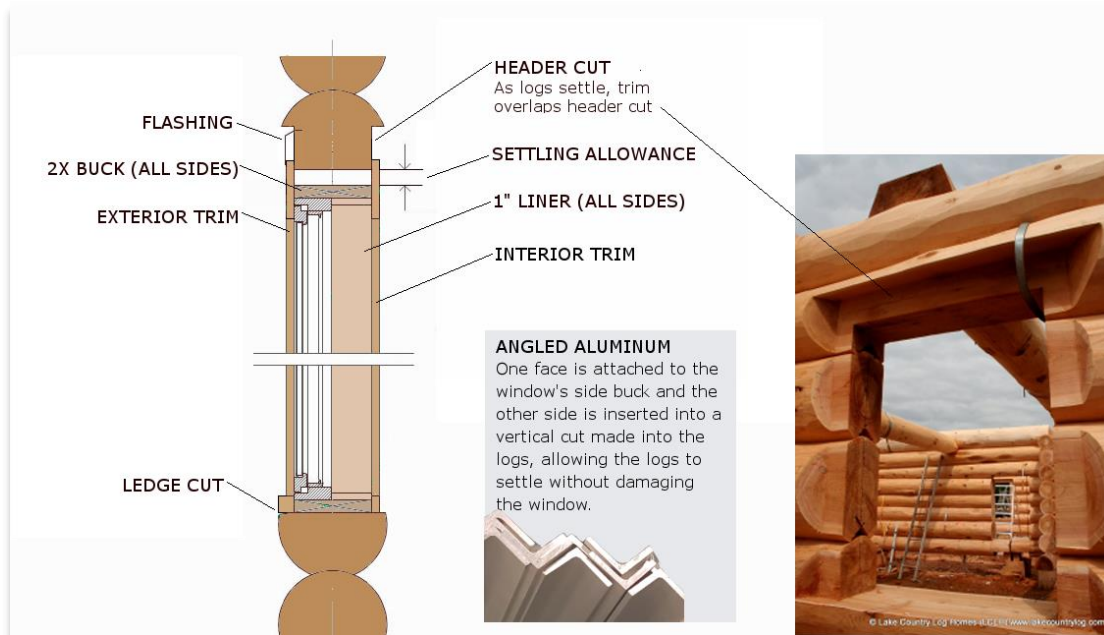

Gaskets and Insulations

P-Gasket

P-Gasket prevents heat loss through the notches and laterals of your log home. Its' innovative design incorporates a closed cell skin and an open cell interior structure. The closed cell skin gives a waterproof quality, meaning it can be

Gaskets and Insulations (cont'd)

installed in any weather without it wicking moisture. The open cell interior structure makes it highly compressible and allows for a tight seal. Finally, it is made of an environmentally friendly material that is light weight and doesn't off gas.

Mineral Wool Insulation

Mineral wool is fireproof, absorbs sound and does not absorb moisture. It's insulating properties are better than standard fiberglass insulation. In the photo to the left you can see how mineral wool is used in combination with P-Gasket in the notches and laterals of a log home.



Bolting and Hardware

We provide all hardware required for the assembly of your log shell package.

This includes:

- GRK Screws for Bottom Round
- 5/8" Galvanized Through-bolts with nuts and washers
- Post settling jacks for main floor posts
- Plated Lag Screws for Trusses, Stair Installation etc. if required
- GRK Screws & Pins for Post to Beam Connections & Top Round
- Angled Aluminum Bars for Log Wall Window and Door Openings



Beautiful Handcrafted Stairs and Railings

Log Stairs

Pre-Assembled Log Stairs and landing (if required) are included for the interior main floor to upper floor.

Styles Available

- ½ Log Treads and Stringers
- Full Log Stringers with Treads notched through
- Spiral Stairs
- Timber Stairs

Log Railing

- Pre-assembled Log Railing is included for the interior stairs, upper floor loft edge and stair well edge
- Available only in Western Red Cedar
- Optional: exterior and basement railings

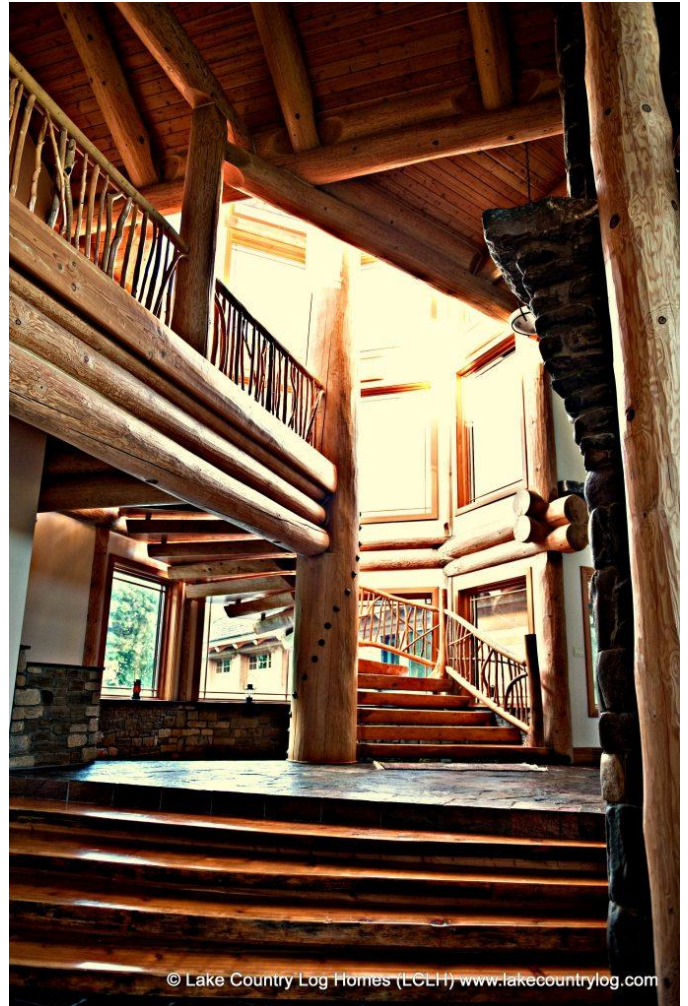

© Lake Country Log Homes (LCLH) www.lakecountrylog.com

Shipping & Set-up

Logistics Expertise

Our staff has decades of experience facilitating shipment of log homes to clients all over the world. We will prepare all the paperwork and arrange for the timely delivery of your log shell package. (Client pays shipping company directly)

Assembly Drawings

Digital and printed copies of tagged assembly drawings will be provided.

On-Site Technical Advisor

Lake Country will send one or more of its' most experienced builders to ensure the assembly of your log shell is carried out efficiently and accurately. The advisor will work closely with you, your contractor and all your construction staff towards a successful assembly.



© Lake Country Log Homes (LCLH) www.lakecountrylog.com